

General Ecology, Inc. Seagull® IV Drinking Water Purifiers



Residential point-of-use and whole house systems
AS9100D:2016, EN9100:2016, JISQ9100:2016, ISO9001:2015
Original Equipment and FAA PMA Manufacturer.

GENERAL ECOLOGY, INC.

151 Sheree Boulevard, Exton, PA 19341 USA

(610) 363-7900 • fax: (610) 363-0412

www.generalecology.com • e-mail: info@generalecology.com

Made in the USA

the pure science of safe water™

General Ecology, Inc.



General Ecology, Inc.
A Loar Group Company



All claims not in accordance with local or state laws are hereby withdrawn.
Performance may vary according to influent water quality. • 200214A

INSTALLATION AND PRODUCT USE GUIDE

NATURE PURE® QC • Select

DRINKING WATER SYSTEM



Faucet included
with Part No. 420604

Faucet not included
with Part No. 420614

System Tested and Certified by NSF International against NSF/ANSI Standard 42 and 53 for the reduction of lead, cysts, chlorine, taste and odor.



General Ecology, Inc.

151 Sheree Blvd.

Exton, PA 19341

www.generalecology.com

610-363-7900

A Loar Group Company

System Model

Nature Pure QC2 Select QC2-PB Part No. 420604

Nature Pure QC2 Select QC2-PB Basic Part No. 420614

Replacement

Element PB-2QC Part No. 420624

Max Pressure 689 kPa (100 psig)

Max Temperature 38°C (100 °F)

Rated Service Flow 2.8 L/min (0.75 gpm)

Rated Capacity 2,800 Liters (750 gallons)

For Cold Water Use.

This system should be installed to comply with state and local laws and regulations

After installation of a new cartridge the system should be flushed at full flow rate for six (6) minutes to purge air and fines from the system.

Cartridge capacity will be effected by source water quality and system operating conditions

Do not use with water that is microbiologically unsafe or of unknown quality without adequate disinfection before or after the system.

Systems certified for cyst reduction may be used on disinfected waters that may contain filterable cysts.

Cartridge should be replaced after 750 gallons, annually, when flow rate decreases or if unusual taste or odor is observed.

Replacement cartridges are available from your local distributor or from General Ecology, Inc.

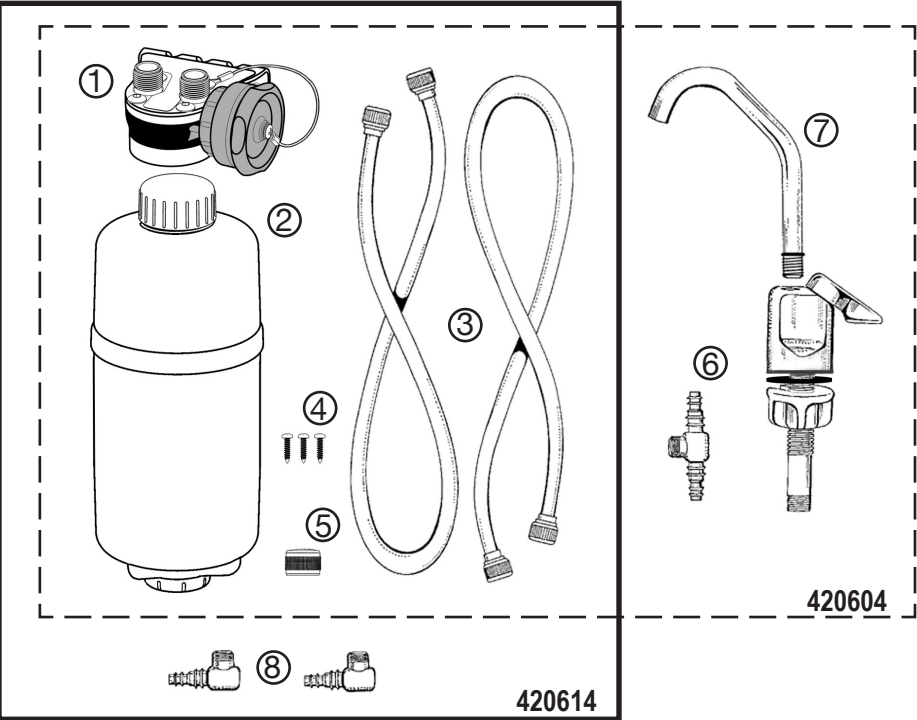

No	Part Description	Quantity	Part No.
1.	NPQC 18-8 stainless steel Interface with bracket with tethered Sanitary bracket with tethered Sanitary By-Pass Connector	1	420350
2.	PB-2QC Canister with Sanitary Cap	1	420624
3.	30" Connector Hose, 1/16" - 24 threads, (3/8" compression fitting)	2	400104
4.	Mounting Screws	3	700562
5.	Cap Nut	1	800349
6.	Plastic T*	1	400180
7.	Ceramic Disc Faucet*	1	707218
8.	Plastic Elbow**	2	400183

*Not included with Part No. 420614

** Not included with Part No. 420604

REPLACEMENT CANISTER INSTALLATION

There is no need to turn off water supply during canister changing. Water flow is automatically turned off within the Interface when the spent canister is being removed, and turned on when new canister is sufficiently seated.

1. Place a small container under the NPQC2 System to catch any water that is in the old canister. Unthread and remove the old Canister (fig. 1) and discard.
2. Remove the sanitary cap (fig. 2) from the replacement Canister and save for winter canister storage.
3. Thread on new Canister (fig. 3). Water flows when Canister is fully seated.
4. Open faucet, and run water through the system to remove loose particles and trapped air.

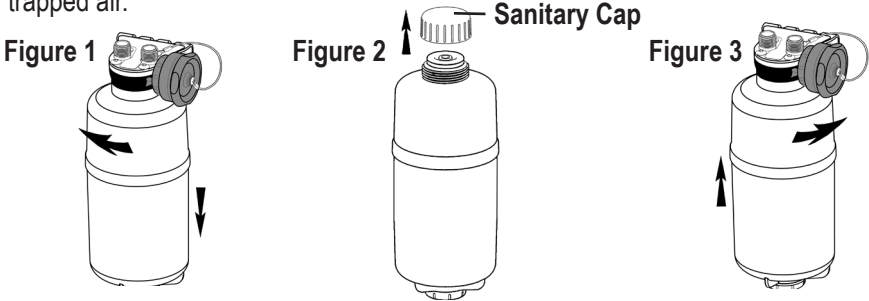

WINTERIZING INSTRUCTIONS

1. Turn off water supply for long-term storage without Canister.
2. Remove the Canister (fig. 1), invert to drain loose water, and allow Canister to air dry.
3. Install the sanitary cap that came with your Canister (fig. 2). Store in a clean, dry, non-freezing area.
4. Remove the stored sanitary by-pass connector (fig. 3) and thread into the NPQC Interface Unit. Allowing continuous water flow through the plumbing system for sanitization as well as winterization.

Note: Be sure to completely flush antifreeze from water system before reinstalling the Canister. Do not permit antifreeze to enter the Canister.

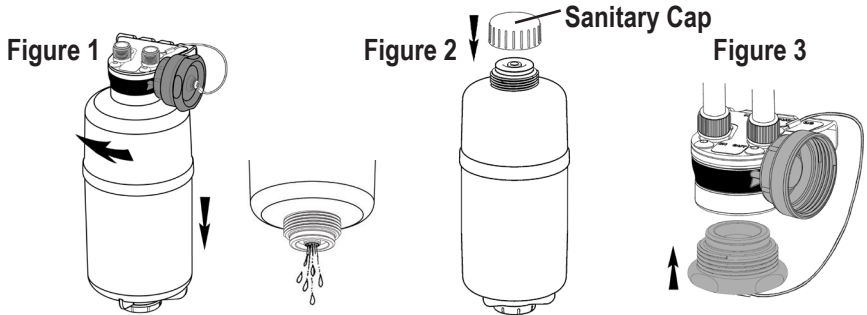

USE and CARE

Your **Nature Pure QC2 • Select Water System** is manufactured in the USA from the finest materials available. If properly cared for, it will provide convenient, effective operation. To clean Faucet and Interface surfaces properly, use a small amount of **nonabrasive** liquid detergent and a soft wet cloth. Gently rub the soiled surface until the dirt is removed. Then rinse clean and wipe with a dry soft cloth.

Hard water may leave mineral deposits or “water spots” if not cleaned regularly. These deposits may resist cleaning with simple liquid detergents, but usually can be removed using a small amount of vinegar, or other mild acid solution applied directly and rubbing with a soft cloth. **Polished Stainless Steel and Chrome coatings should not be cleaned with abrasive or pumice type cleansers.** They may permanently scratch or otherwise mar the surfaces.

Nature Pure QC 2 Canisters should be replaced as indicated on data sheet, when flow decreases noticeably, and at a minimum of every two years. Canister media life may vary depending upon input water quality. Please note that although water flow is automatically turned off when the Canister is being removed, and turned on when new Canister is sufficiently seated, we recommend that a water supply valve be installed at a readily accessible nearby location to facilitate installation and canister changes.

For long term storage, remove Canister from Interface and allow to air dry. Install the saved sanitary cap that came with your Canister. Store in a clean dry area. Install Sanitary By-Pass connector on Interface.

Nature Pure QC Interface only, has a 5 year limited manufacturer's warranty when used according to directions. Please check your Interface Unit for signs of wear that may indicate need for replacement. Refer to warranty card for specific terms and conditions.

For Nature Pure QC2 Basic Model Installation

(Faucet not included with Basic Model)

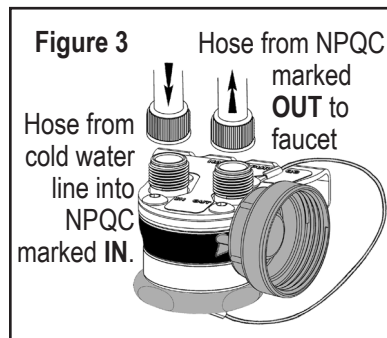
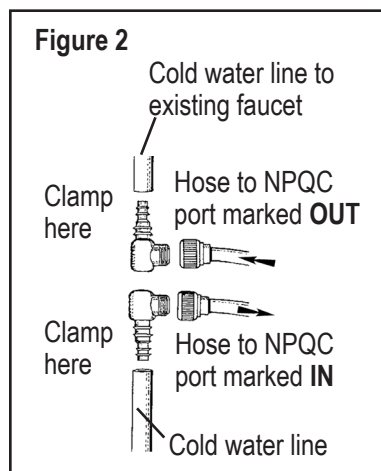
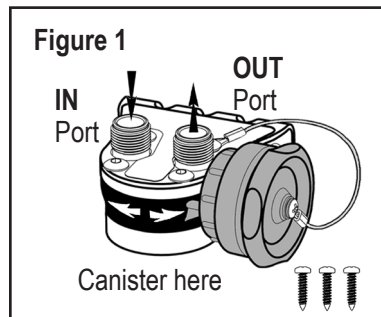

It is recommended that an inlet line shut-off valve be installed.

1. Turn off cold water supply.
2. Position and Install Interface Unit in a **vertical orientation** with canister below Interface (**fig. 1**) on inside wall under sink in a location that allows easy access for Canister replacement using the 3 screws provided (sanitary by-pass connector holder rotates to allow access to screw holes on bracket). **Do not remove bracket from Interface.** Make sure 30" inlet and outlet connector lines reach connection points.
3. Check the size of the plastic cold water supply line under the sink going to existing faucet to ensure the supplied elbows will fit. If necessary, cut cold water line (be sure to square-off cut) and attach the supplied elbows and secure with **owner supplied** hose clamps (**fig. 2**). Attach one supplied 30" connector hose to the cold water supply line, and the other end of the hose to the port marked **IN** on the **NPQC Interface Unit**. Attach one end of the second supplied 30" hose to the port marked **OUT** on the **NPQC Interface Unit** and that hose's other end to the cold water line going to the faucet (**fig. 3**).
4. Remove tethered sanitary by-pass connector from **NPQC Interface Unit** and store in the holder on the **Interface** (**fig. 4**).
5. Thread on the **PB-2QC Canister**.
6. Slowly turn on the cold water and check for leaks.
7. Open faucet, and run water through the **NPQC2 System** to remove loose particles and air trapped during the manufacturing process.

WARRANTY

Please remember to complete and return the Warranty Card within ten days of purchase. You can also register online at www.generalecology.com

For Nature Pure QC2 Faucet Model Installation

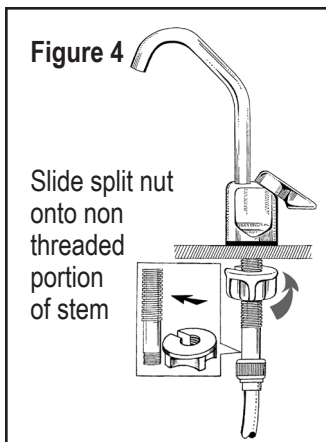
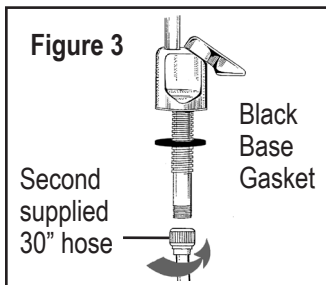
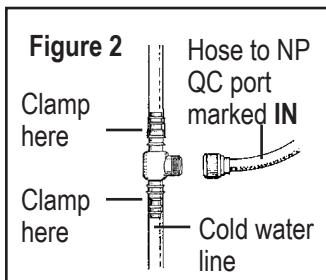
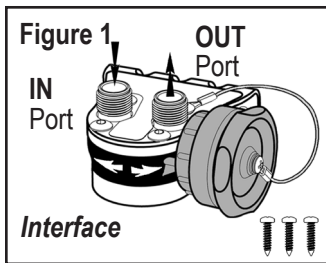

It is recommended that an inlet line shut-off valve be installed.

1. Turn off cold water supply.
2. Position and Install Interface Unit in a **vertical orientation** with canister below Interface (fig. 1) on inside wall under sink in a location that allows easy access for Canister replacement using the 3 screws provided (sanitary by-pass connector holder rotates to allow access to screw holes on bracket). **Do not remove bracket from Interface.** Make sure 30" inlet and outlet connector lines reach connection points.
3. Check the size of the plastic cold water supply line under the sink going to existing faucet to ensure the supplied Plastic T will fit. Cut cold water line under sink going to existing faucet and attach the supplied Plastic T and secure with **owner supplied** hose clamps (fig. 2). Attach one supplied 30" connector hose to the newly installed T in the cold water supply line, and the other end of the hose to the port marked **IN** on the **NPQC Interface Unit**.
4. Determine Water Faucet location and cut a $\frac{3}{4}$ " hole (fits up to a $1\frac{1}{2}$ " hole). Included is a Faucet Mounting Template located at the bottom of the next page. **Be sure to check for proper clearance of faucet stem underneath sink.**
5. Place faucet stem through black base gasket and then securely hand tighten the second supplied hose onto faucet stem (fig. 3).
6. Drop free end of the hose through mounting hole. Position faucet and hand tighten split nut (fig. 4).
7. Attach the end of the second supplied 30" hose to the port marked **OUT** on the **NPQC Interface Unit** (fig. 5).

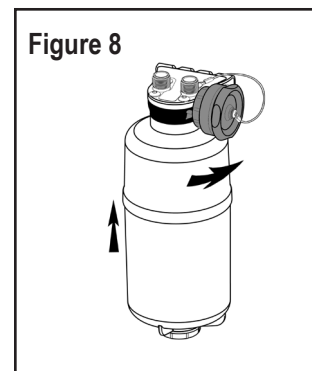
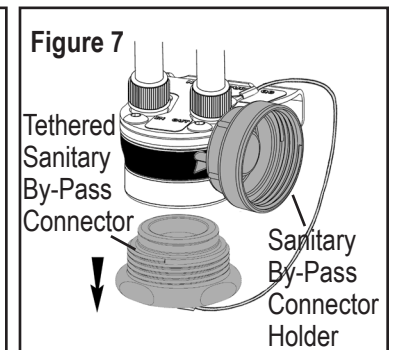
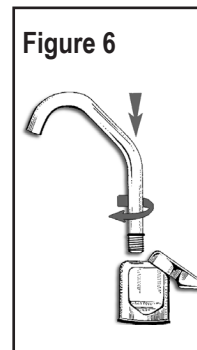
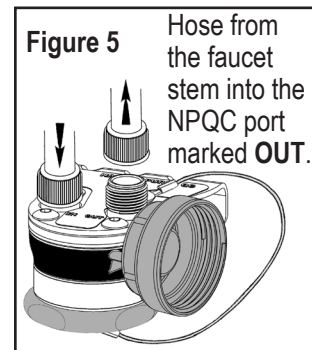

8. Thread spout into base (fig. 6). **Do not over tighten.**
9. Remove tethered sanitary by-pass connector from **NPQC Interface Unit**, (see fig. 7) and store in holder on side of Interface. Thread on the **Canister** (fig. 8).
10. Slowly turn on the cold water and check for leaks.
11. Open water faucet, and run water through the **NPQC System** to remove loose particles and air trapped during the manufacturing process.

FAUCET MOUNTING TEMPLATE

