

# 170

BLEECKER STREET

Southwest Corner  
of Sullivan Street



## Comments:

- Turn key restaurant build out
- Vibrant NYU and tourist corridor
- Fully equipped kitchen with two hoods
- Fully equipped bar in place
- Previous tenant was licensed for sidewalk café and full liquor
- Full length operable windows open to the street
- Three entries, one on Bleecker Street and two on Sullivan Street
- HVAC, venting and upgraded electrical systems
- Basement storage has room for two walk-in freezers
- Lutron lighting system and alarm in place



**SINVIN**  
COMMERCIAL REAL ESTATE & ADVISORY

Ground Level

Lower Level

Frontage

Ceiling Height

Term

Possession

2,000 SF  
APPROX.

750 SF  
APPROX.

19' + 95'  
BLEECKER SULLIVAN

10 FT

Negotiable | Immediate



PRIME CORNER WITH  
WRAPAROUND FRONTAGE

Ground Level

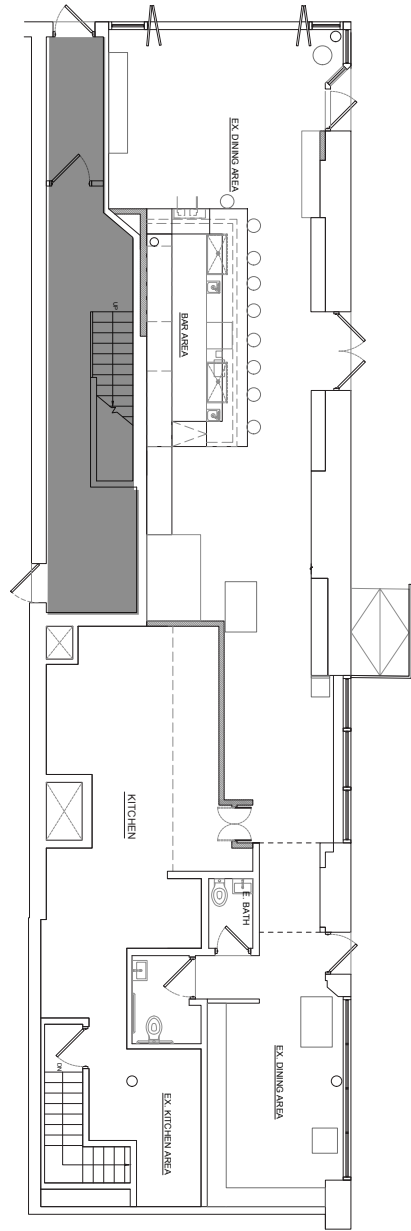

Lower Level

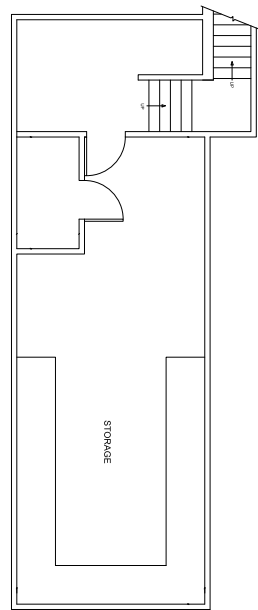

FULLY BUILT AND  
FIXTURED RESTAURANT





## Neighbors Include:

- Mimi on Sullivan
- Thin Cookies
- Lilac Chocolates
- Chloe
- Randy's Donuts
- Motek
- Figo Gelato
- Hello Saigon
- Pizza Box NYC
- Red Lion
- Little Hen
- Super Burrito
- Senza Gluten
- Sullivan Tea & Spice
- Crumbl
- Mermaid Inn
- CVS Pharmacy
- Carbone

## Please Contact:

**Christopher Owles**

212.604.9002 | [chris@sinvin.com](mailto:chris@sinvin.com)

**Margie Sarway**

646.673.8742 | [margie@sinvin.com](mailto:margie@sinvin.com)

 **SINVIN**  
COMMERCIAL REAL ESTATE & ADVISORY



Sullivan Street Entrance